

Section A:A 1:2000 @ A2

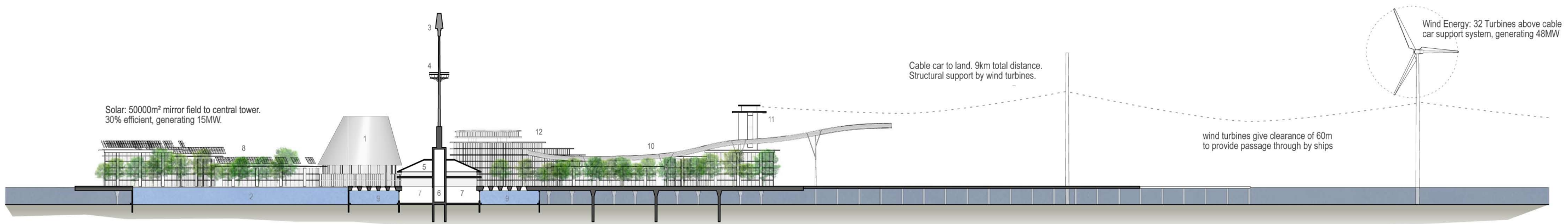

Section B:B 1:2000 @ A2



Energy Production

Solar: 50000m<sup>2</sup> mirror field to central tower. 30% efficient, generating 15MW.  
 Wave Energy: 500m long generator producing 20kW/m. 25% efficiency from wave to wire, generating 2.5MW  
 Wind Energy: 32 Turbines above cable car support system, generating 48MW

Total: Island produces 65.5MW

Key

- 1 \_ Conference centre
- 2 \_ Internal lake
- 3 \_ Solar tower
- 4 \_ Harbour control room
- 5 \_ Solar plant room
- 6 \_ Vertical circulation
- 7 \_ Aquarium
- 8 \_ Solar mirror field
- 9 \_ Marine life containment with light shafts over.
- 10 \_ Canopy over main planted area
- 11 \_ Cable car departure terminal
- 12 \_ Hotel

